

**NOTES**

1. ONLY THOSE VEHICLES LICENSED UNDER THE ROAD TRAFFIC ACT 1974 ARE PERMITTED ON BEACHES, UNLESS NOTED OTHERWISE.
2. ALL AREAS ABOUT THE HIGH WATER MARK (I.E. SAND DUNES)
3. SAND BOARDING IS PROHIBITED ON ALL BEACHES/ FORESHORE/ SAND DUNES WITH THE SHIRE OF CAPEL.
4. AREAS NOT MARKED AS "DOG PROHIBITED AREAS" ARE DOG EXERCISE AREAS.
5. NO MOTOR BIKES ON BEACHES AND RESERVES

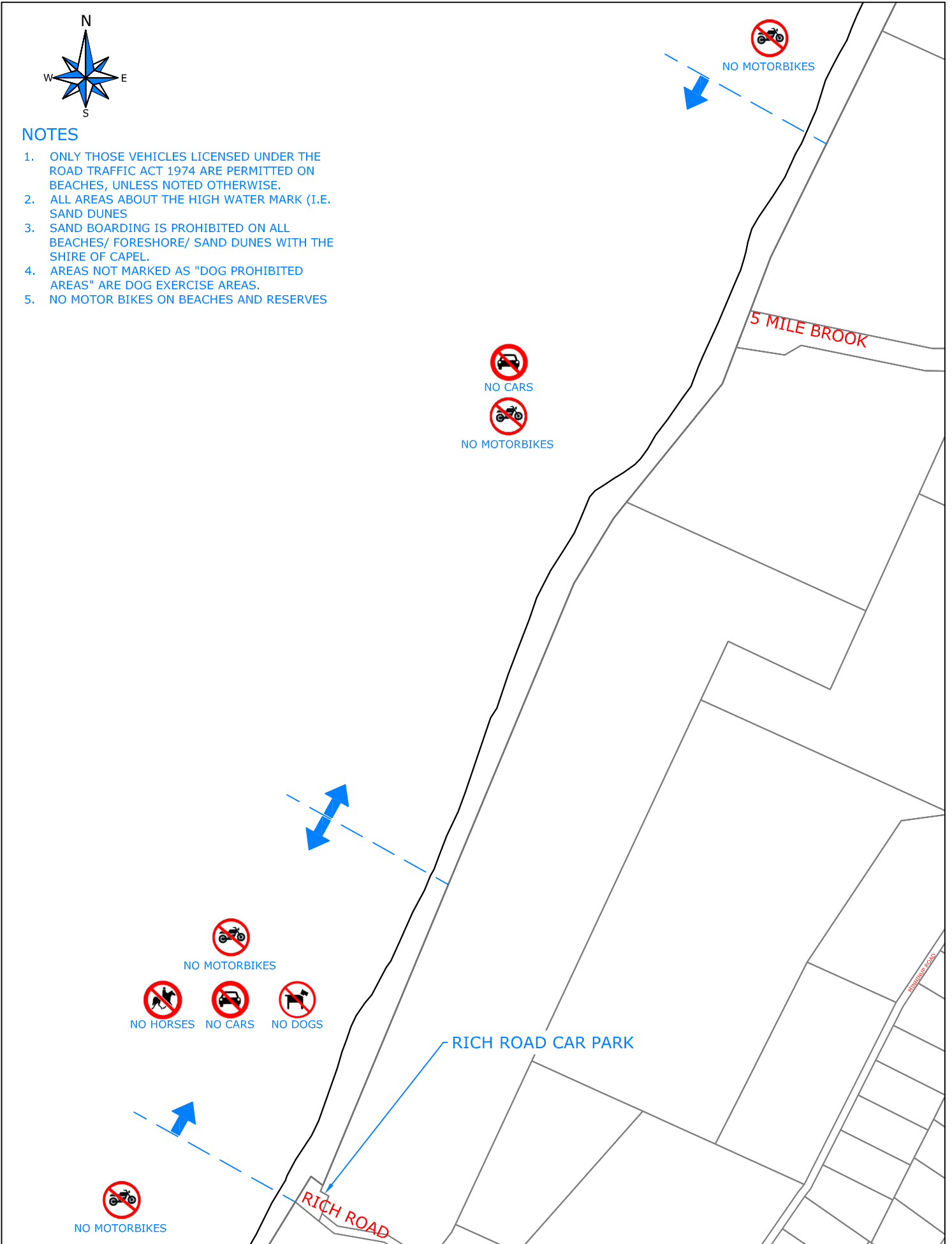

**COPYRIGHT**  
 The concepts and information contained in this document are the Copyright of Shire of Capel. Use or copying of the document in whole or part without the written permission of Shire of Capel constitutes an infringement of copyright.  
 This plan is not to be used for construction unless issued as rev 0 or higher and signed as "Approved"

**PROJECT:**  
 SHIRE OF CAPEL PROHIBITED BEACH AREAS  
**TITLE:**  
 STRATHAM

**DATE:**  
 26/2/2016  
**SCALE:**  
 N.T.S.  
**DRAWN:**  
 T.GOULD

<b>DRAWING NO.</b>	
<b>FILE LOCATION:</b>	
<b>SHEET</b>	<b>ISSUE</b>